

  
**ATT INOX DRAIN**  
Stainless Steel Engineering

# Siphon

Cleaning manual



[www.att.eu](http://www.att.eu)



## Cleaning procedure for Siphons W200/W300 V/H types.

After pulling the siphon out from the drain body, unscrew the upper part.

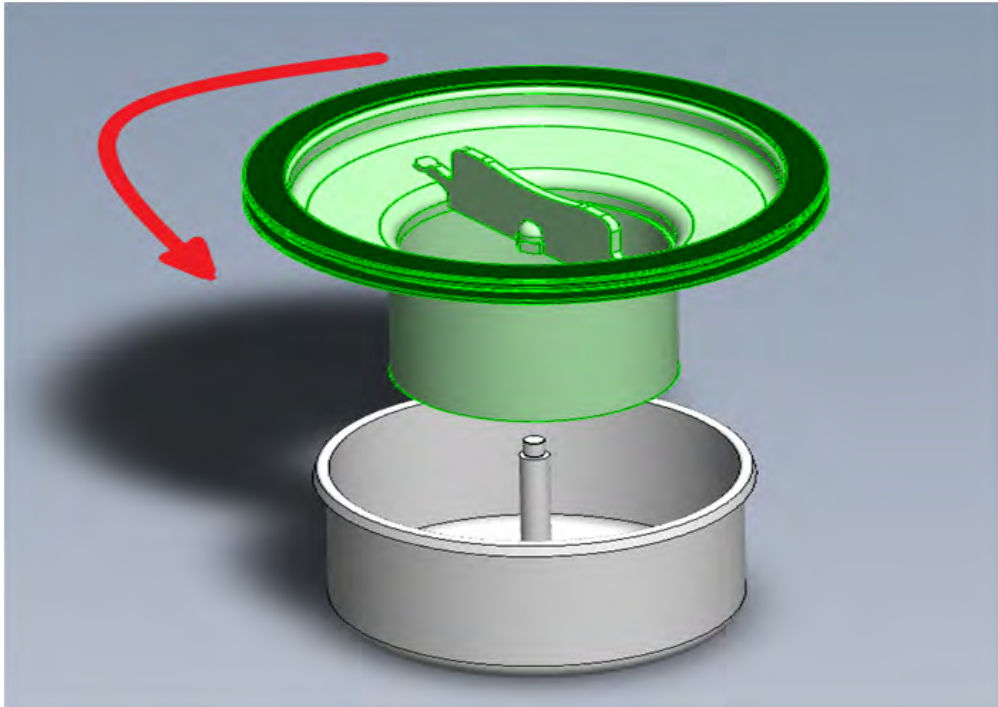

Clean the upper and lower parts of the product from dirt.  
*Use stainless steel brushes if necessary.*

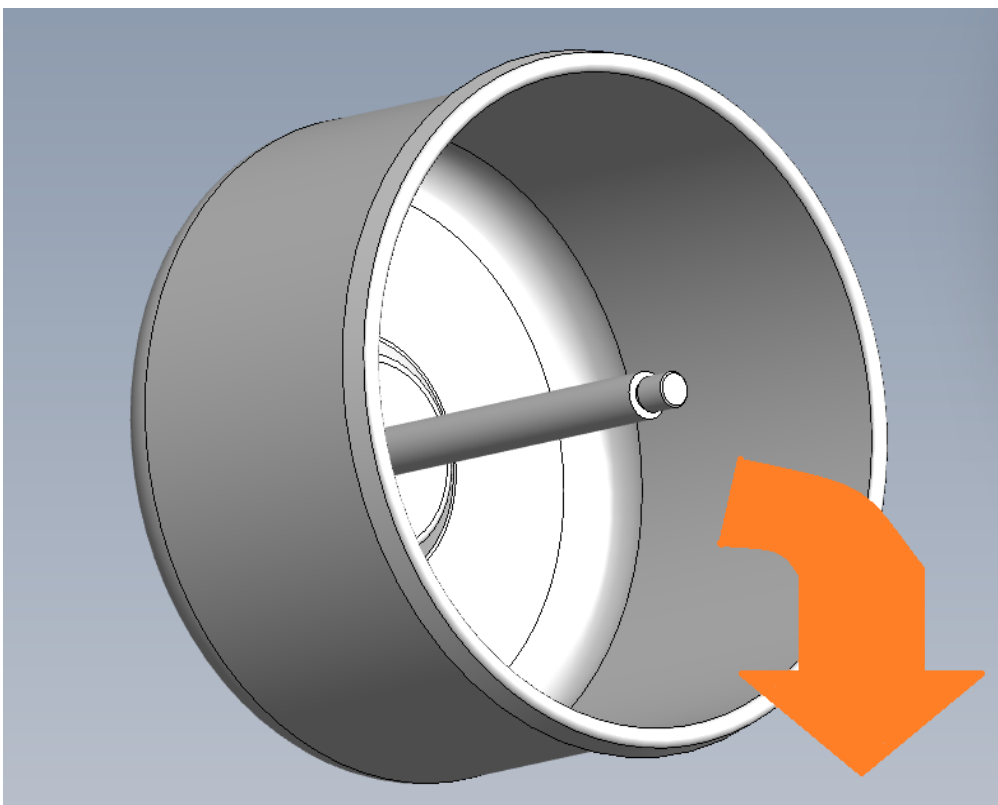

After the washing, lubricate the thread on the stem (copper grease) and the gasket (slip paste for sanitary connections) and screw the elements together again.

The flow in the siphon is 51 mm, to which the upper part is recessed into the lower part so a tolerance of 2-3 mm in the horizontal position does not change the functionality of the element.

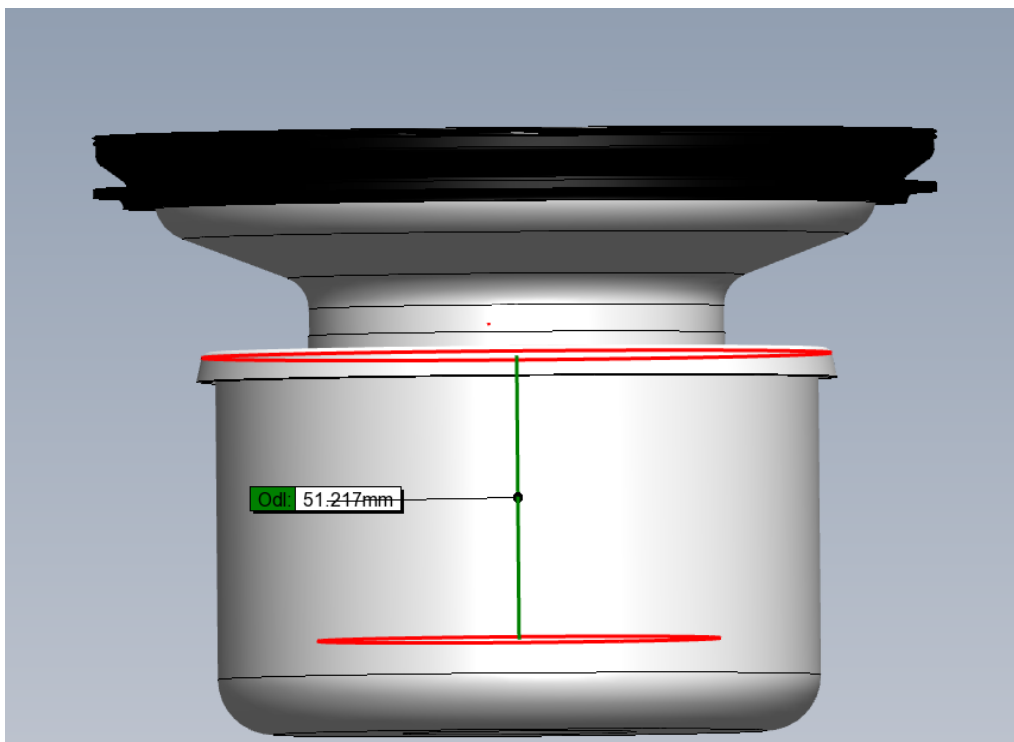

**CAUTION:** Do not clean the siphon by hitting the surface of the lower or upper part without unscrewing it in the first place.