



ATT INOX DRAIN
Stainless Steel Engineering

Kitchen Channels



www.att.eu

BIM files
bim.att.eu

General Informations

Kitchen channels are used in hotels, restaurants, schools and hospitals. Produced in accordance with PN-EN 1433 and PN-EN 1253 standards, meeting the highest hygiene norms of the European food industry, in a factory certified by TÜV Rheinland.

In places such as professional kitchens, properly designed floor drainage is a guarantee of maintaining safety and hygiene of the workplace.

Kitchen channels produced by ATT are made of stainless steel EN 1.4301 (AISI 304) and EN 1.4404 (AISI 316). Both types of metal have high resistance to corrosion and chemicals used in CIP processes (cleaning in place). The corrosion resistance of these materials is guaranteed by the pickling and passivation process to which each product leaving our warehouse is subjected.



Features

tailored to individual project requirements

- designed with a suitable buffer, suitable for large discharges, e.g. for washing and draining boilers
 - easy to clean
 - available with mesh or ladder grating; depending on load class.
- The grates have an anti-slip surface (according to DIN 51130)
- can be combined with other sewer elements such as point drainages and channels
 - may have finished edges depending on the type of flooring and required load
 - different variants of point drainages.



General Informations

The main parameters you should pay attention to when choosing a drainage system:

- amount of drained medium
- floor slope
- load class
- dimensions

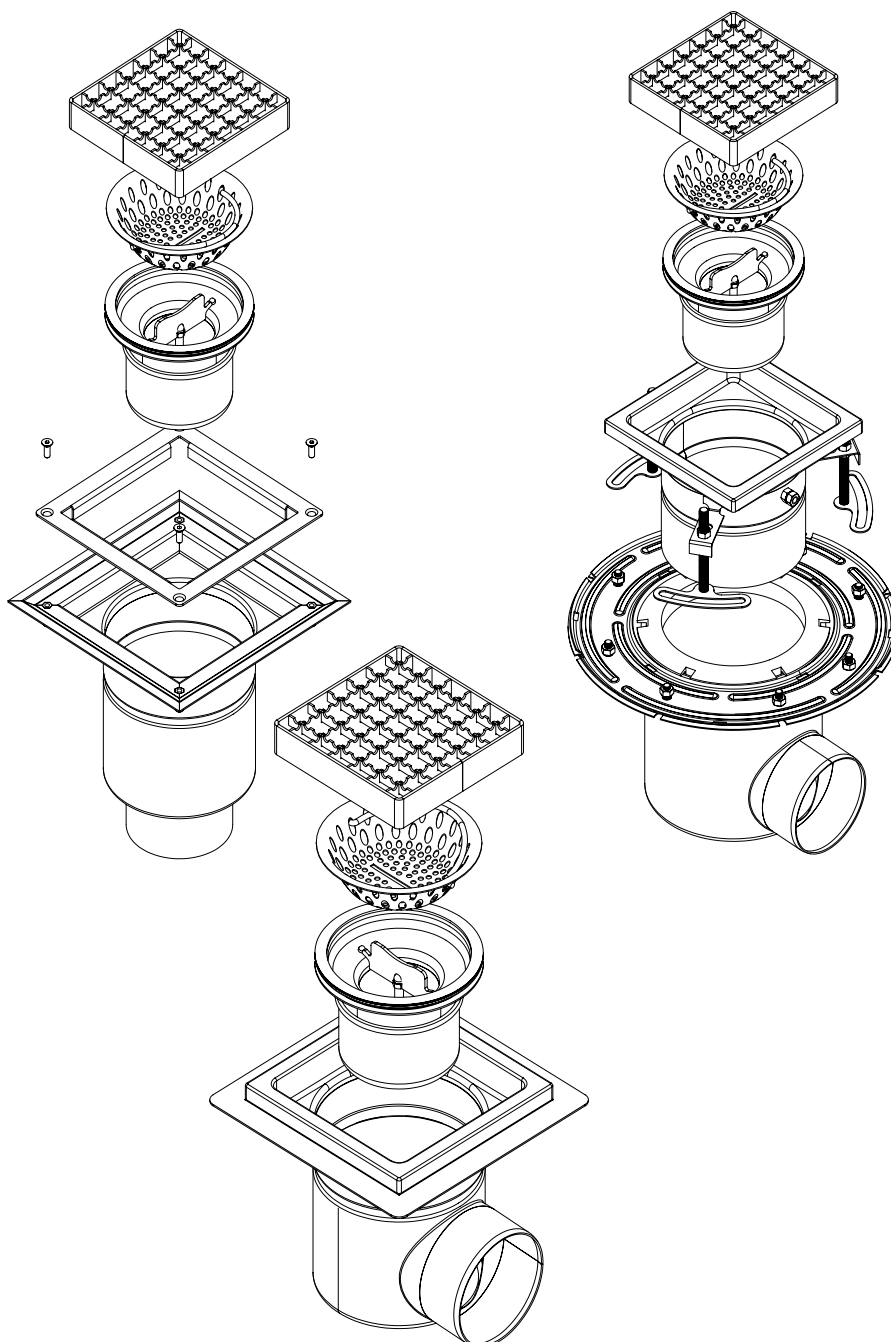

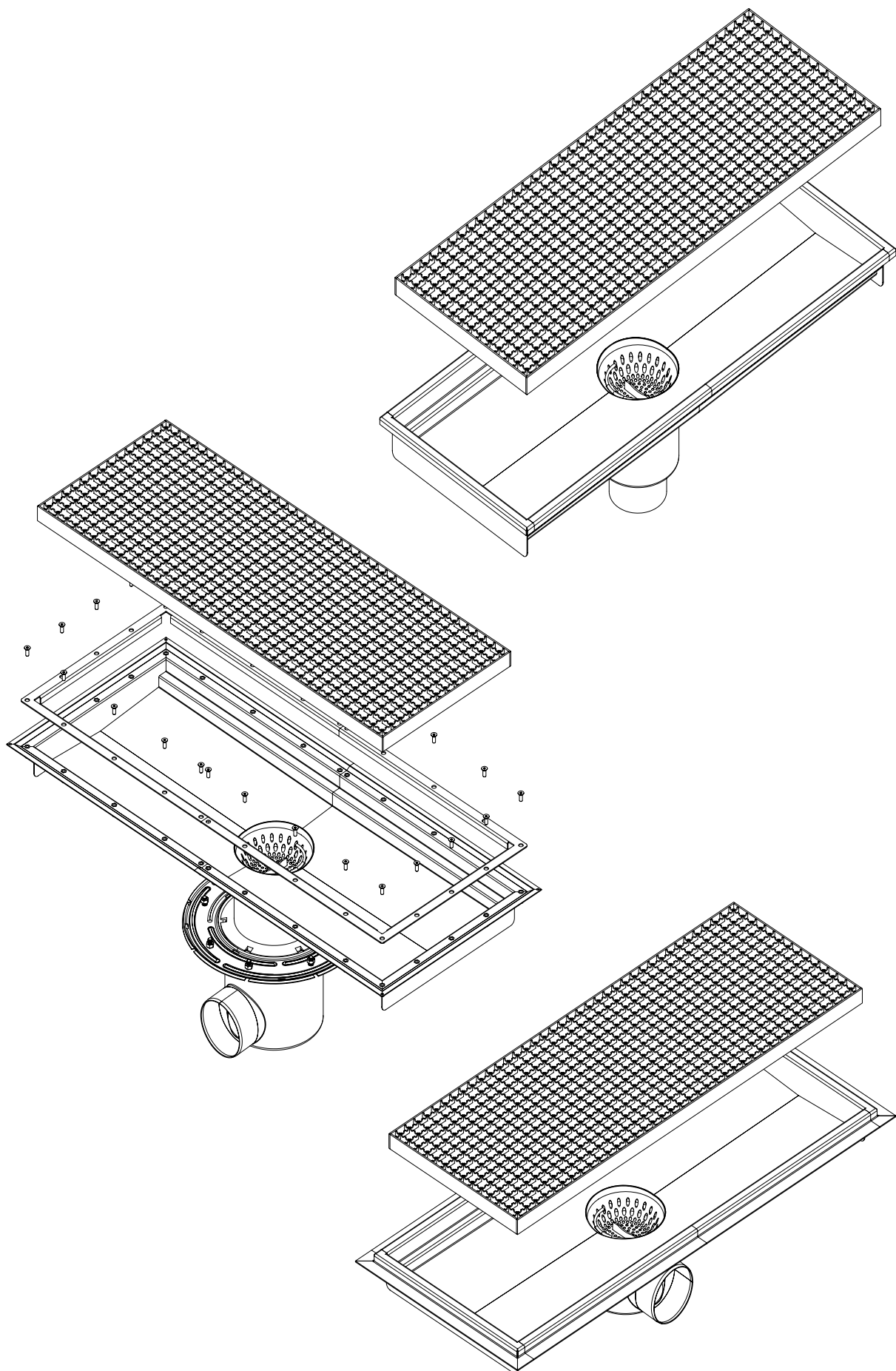

FLOOR DRAIN W200/110 with square upper part

Option: standard

vertical outlet, single-part W200/110 V1*

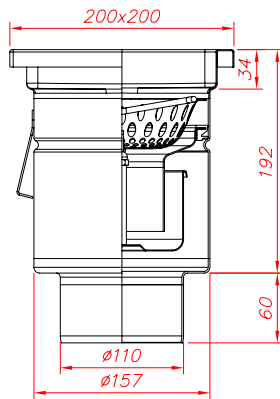

horizontal outlet, single-part W200/110 H1*

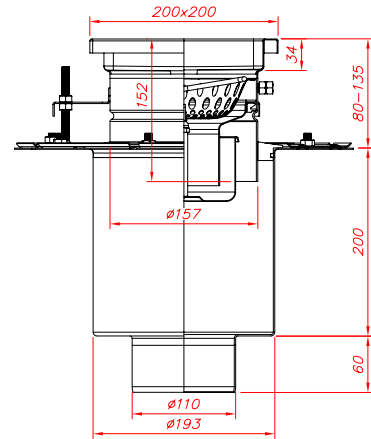

vertical outlet, two-part W200/110 V2*

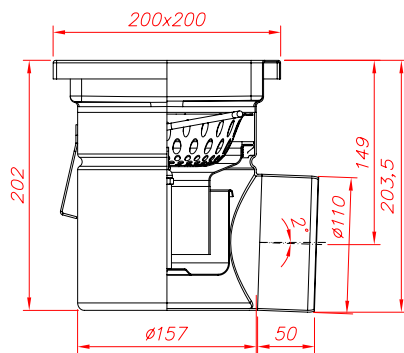

horizontal outlet, two-part W200/110 H2*

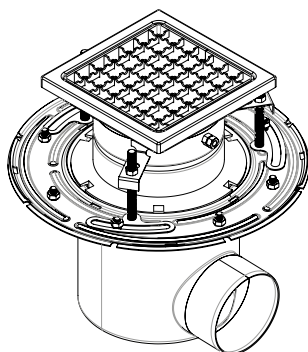
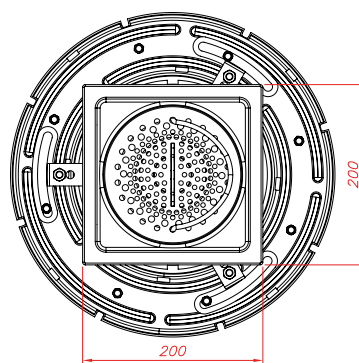
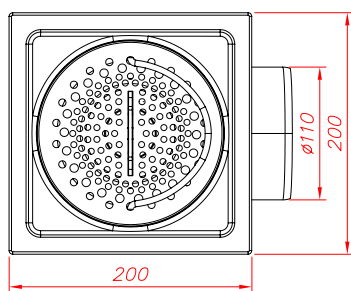
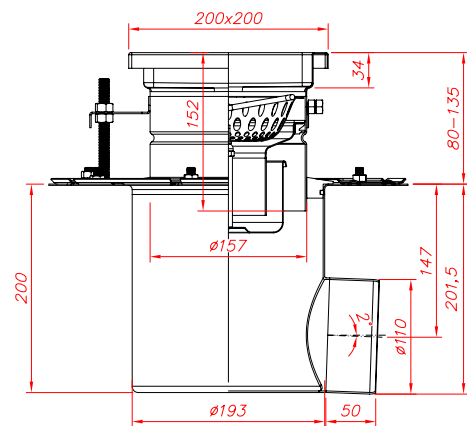

*available grating options: anti-slip mesh (K), ladder (D), plate (P), perforated sheet (B)

Specifications:

height of water seal 50 mm

flow rate 2,1 l/s

FLOOR DRAIN W200/110 with square upper part

Option: with FLANGE for tiling floor

vertical outlet, single-part W200/110 V1*

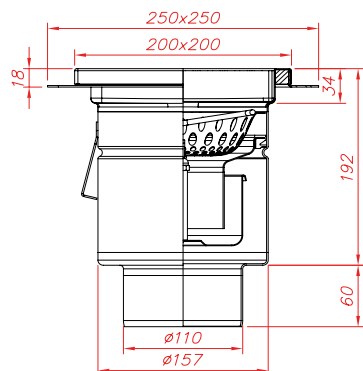

horizontal outlet, single-part W200/110 H1*

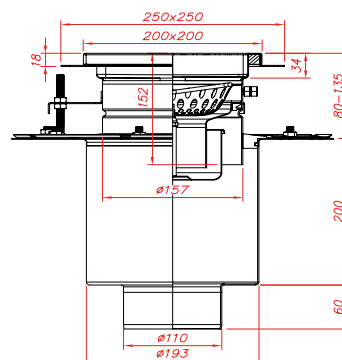

vertical outlet, two-part W200/110 V2*

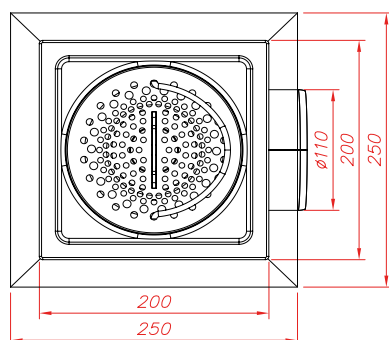
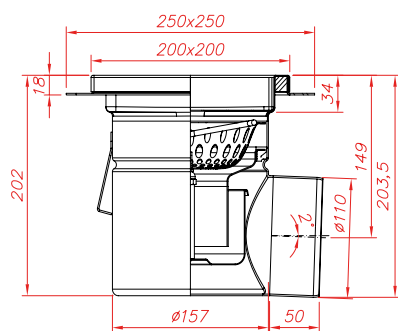

horizontal outlet, two-part W200/110 H2*

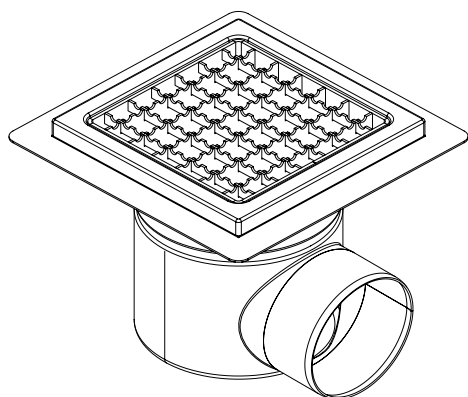
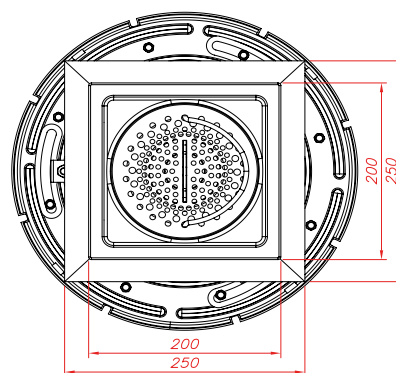
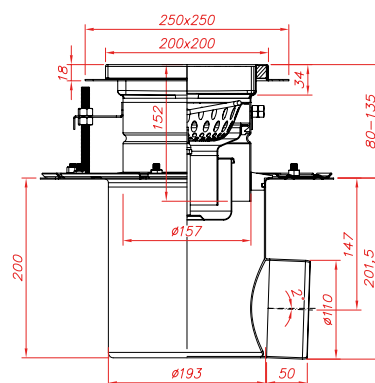

*available grating options: anti-slip mesh (K), ladder (D), plate (P), perforated sheet (B)

Specifications:

height of water seal 50 mm

flow rate 2,1 l/s

FLOOR DRAIN W200/110 with square upper part

Option: for vinyl floor application

vertical outlet, single-part W200/110 V1*

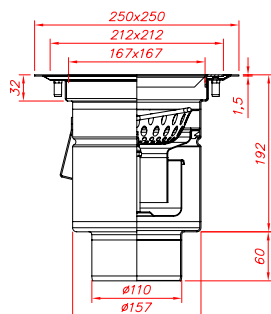

horizontal outlet, single part W200/110 H1*

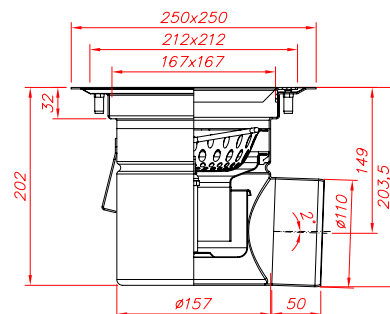

vertical outlet, two-part W200/110 V2*

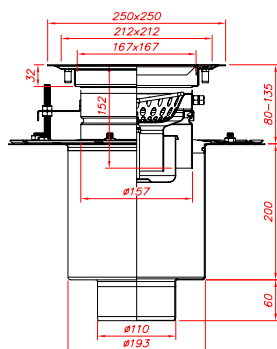

horizontal outlet, two-part W200/110 H2*

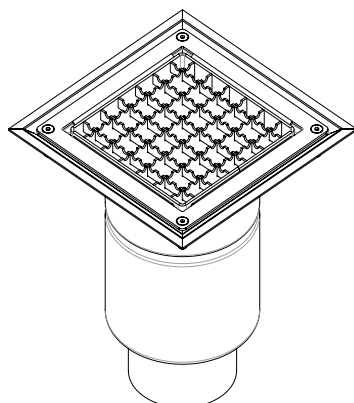
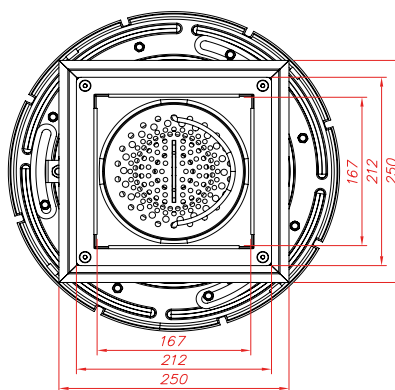
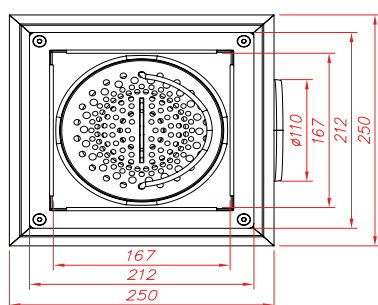
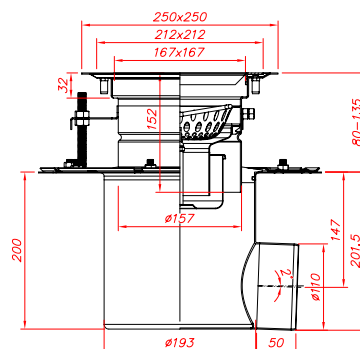

*available grating options: anti-slip mesh (K), ladder (D), plate (P), perforated sheet (B)

Specifications:

height of water seal 50 mm

flow rate 2,1 l/s

basket volume 0,45 l

S500 lenght 1000 mm

Option: standard

vertical outlet, single-part W200/110 V1*

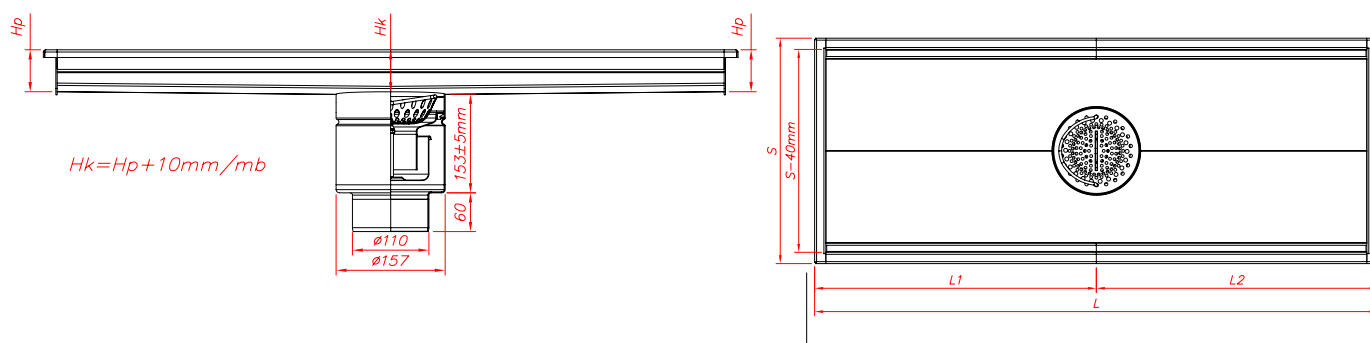

vertical outlet, two-part W200/110 V2*

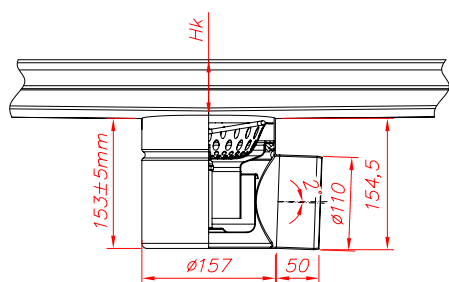

horizontal outlet, two-part W200/110 H2*

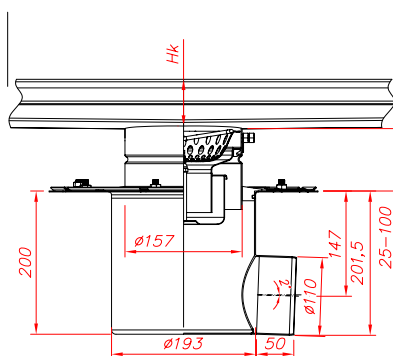

horizontal outlet, single-part W200/110 H1*

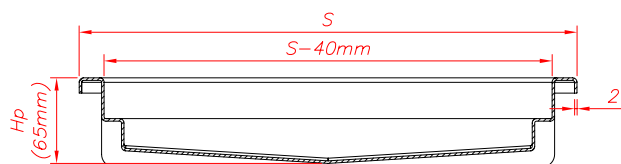
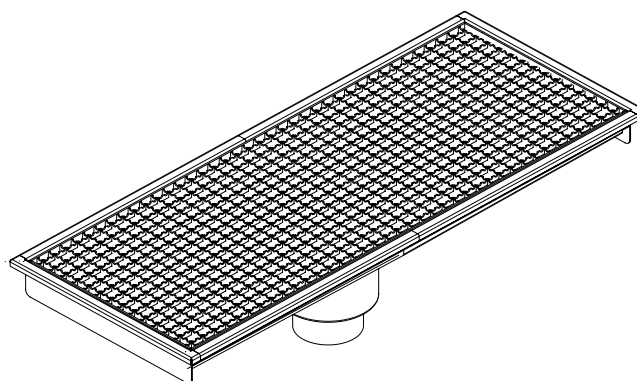
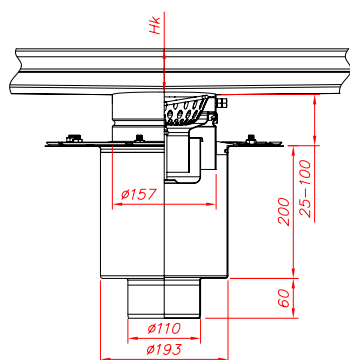

S500 lenght 1000 mm
Option: for vinyl floor application

vertical outlet, single-part W200/110 V1*

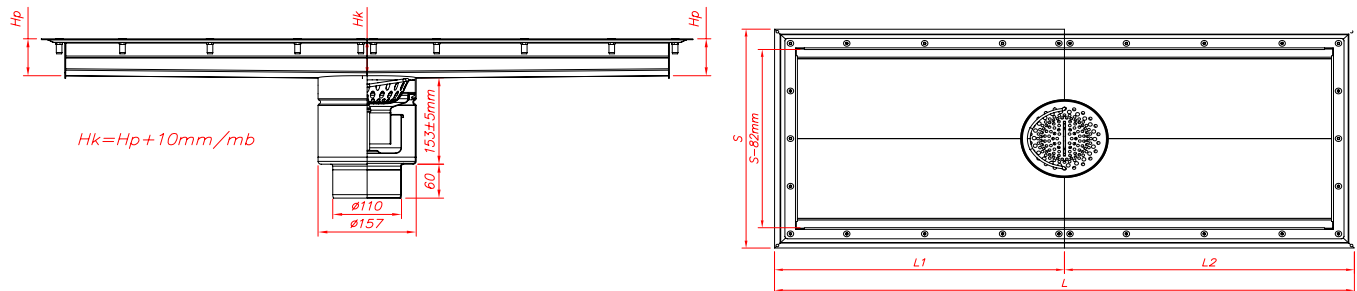

vertical outlet, two-part W200/110 V2*

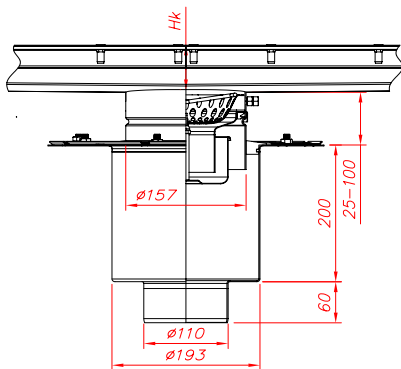

horizontal outlet, single-part W200/110 H1*

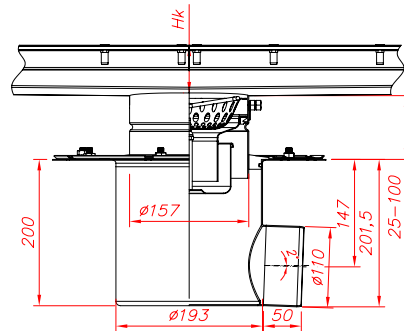

horizontal outlet, two-part W200/110 H2*

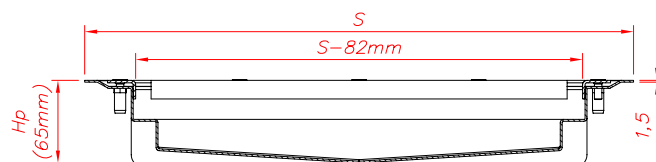
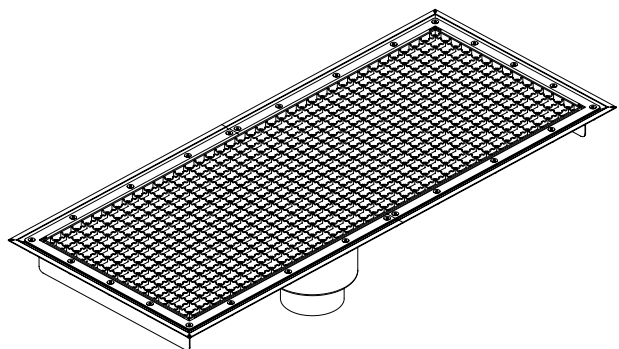
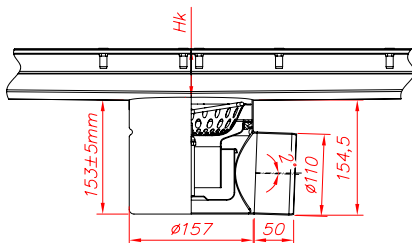

S500 lenght 1000 mm

Option: with FLANGE for tiling floor

vertical outlet, single-part W200/110 V1*

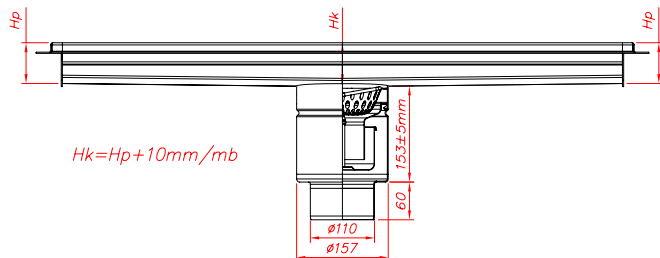

horizontal outlet, single-part W200/110 H1*

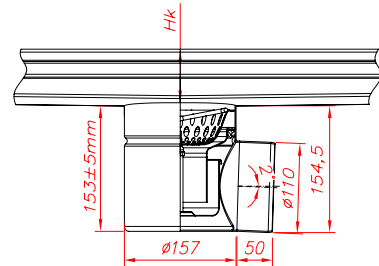

vertical outlet, two-part W200/110 V2*

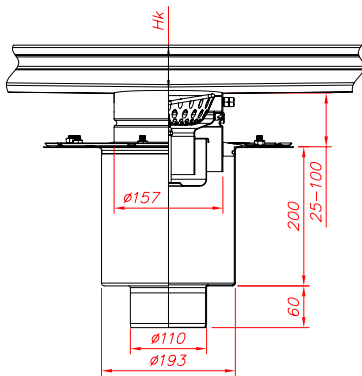

horizontal outlet, two-part W200/110 H2*

