



ATT INOX DRAIN
Stainless Steel Engineering

Bathroom Wall Drainage

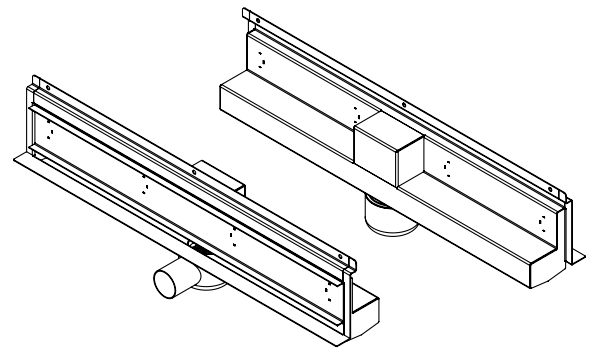

A drainage design where form meets function as the BWD series single body drain system provides a barrier-free channel which is easy to install and maintain.

**BWD-FLANGELESS**

General Info

BWD Series is a two-piece low profile wall recess linear drain, that is specifically designed for a truly invisible floor drainage for an easy installation and with bonded waterproofing membrane.

BWD drain is designed to accommodate large, small format tiles or stone installations in a shower with a single plane slope to the drain. Our linear drain is designed for commercial or residential projects and is intended for interior applications.

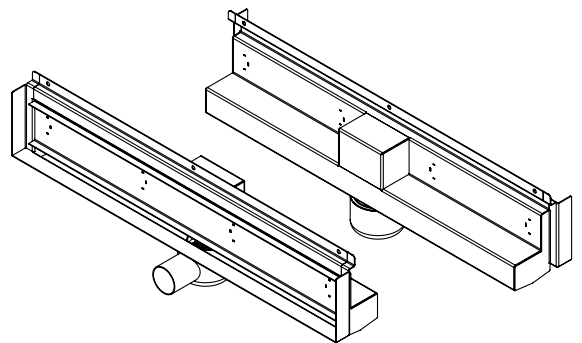
**BWD - FLANGE**

Minimalism
in design

Advantages

- Single slope to drain
- Allows for the use of tiles of any size and format
- Applicability of tiles into grating that blend with floor design
- Made from heavy duty 304 stainless steel provides for long-lasting performance

Suitable Substrates

- Concrete
- Exterior Glue Plywood (Interior Only)
- Cement Backer Board
- Cement Mortar Bed

Product Attributes

- Application: Commercial and Residential
- Color/Finish Category: Stainless Steel
- Color/Finish Name: Polished Stainless Steel
- Diameter: 50 mm
- Drain Opening: 50 mm
- Fits Pipe Size: 50 mm
- Material: Stainless Steel
- Material Type: AISI-304 SS (AISI-316 available upon request)

Part No.	Total Lenght [mm]	Visible Lenght [mm]
DUW-T-R-700	738	700
DUW-T-R-33	838	800
DUW-T-R-39	938	900

Front View

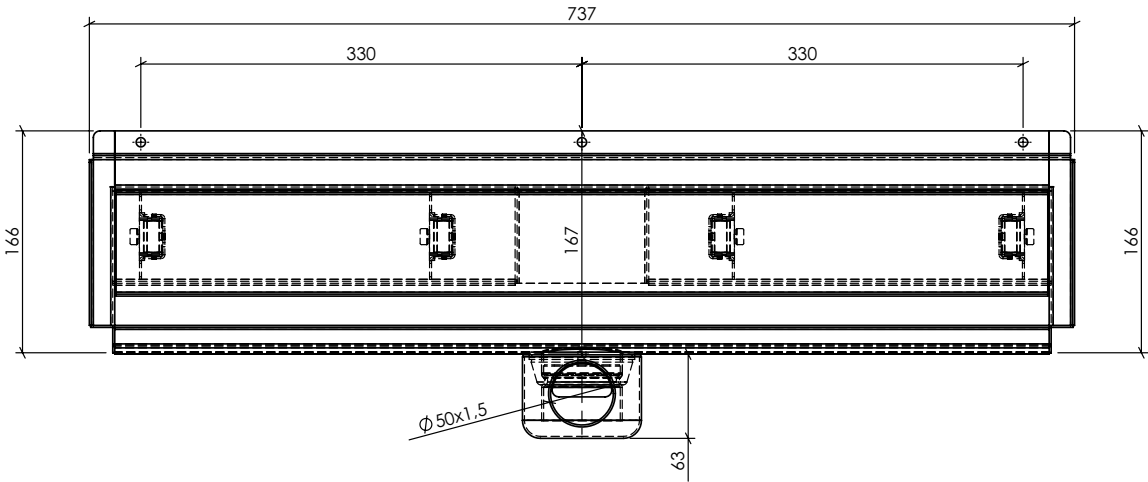

Top View

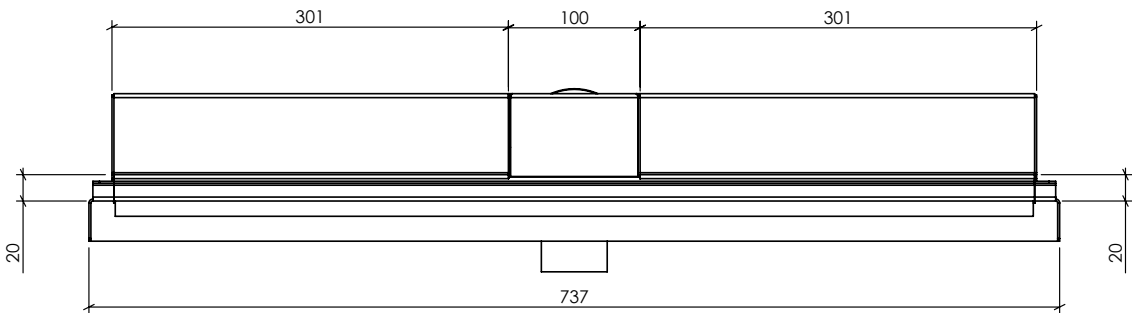

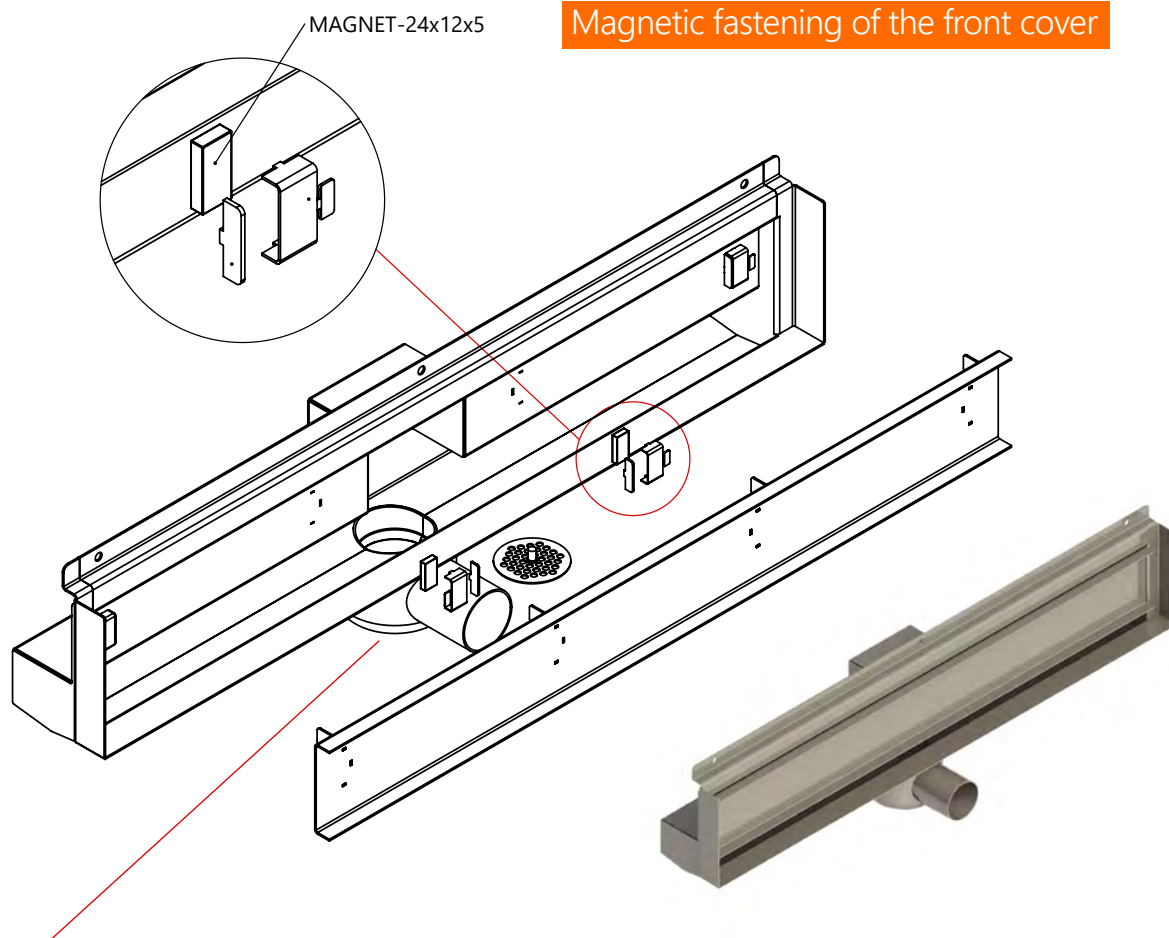

Magnetic fastening of the front cover

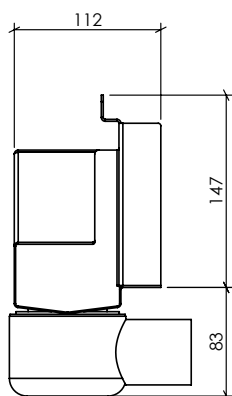

360 degrees rotating siphon



Maintenance

The BWD drain system is made from durable, non-porous, hygienic, and rust-free stainless steel. Prior to cleaning, carefully remove the grate for either end of the drain using the extraction tool.

Exposed surfaces of the BWD drain System may be cleaned and maintained using mild soaps and a soft cloth. Do not use any abrasive cleaners, scrub pads or allow household cleaning agents to sit on the drain cover for an extended period.

Follow proper maintenance procedures to prevent excessive surface rust. In areas of frequent exposure to salt, chlorine and other chemical compounds, maintenance of the stainless grates should be performed at least 2-3 times per year.